



Renaissance Riverview Plaza Hotel
 Renaissance Battle House Hotel
 Mobile Convention Center

UNLOCKING POTENTIAL: THE POWER OF EDUCATION



MEGA

CONFERENCE 2024



July 8-12, 2024 · Mobile, AL



SPONSORED BY:

American Book Company · College Admissions Made Possible
The Alabama State Department of Education · The Alabama State Board of Education

Blue Cross and Blue Shield of Alabama · Bailey Education Group · AE Touch Technologies
 University of South Alabama - College of Education and Professional Studies
 Ron Austin Law · Alabama Education Association

95 Percent Group · Kids First Education, LLC · Perfection Learning · Wondr Health · Lexia · Plasma Games
 Teaching Strategies · Vital Alabama · Auburn University at Montgomery - College of Education · Columbia Southern University
 Alabama Institute for Deaf and Blind · Public Consulting Group · UWA Black Belt STEM Education Institute



Table of Contents

Schedule-at-a-Glance	3	PLATINUM SPONSORS	26
General Information	4	THURSDAY Sessions	29-32
Opening Session	5	FRIDAY Sessions	33-34
Keynote Speaker	7	MEGA 2024 Presenters	35
Conference Maps	16-17	MEGA 2024 Exhibitors	36
TUESDAY Sessions	20-23	SILVER SPONSORS	37
WEDNESDAY Sessions	24-28	BRONZE SPONSORS	38





MEGA Conference 2024 will begin Monday, July 8, at 1:30 pm with a General Session in the Mobile Convention Center.

Concurrent sessions will be held Tuesday, July 9, through Friday, July 12.

The conference will end Friday, July 12 at the conclusion of the morning sessions.

CONFERENCE APP:



For schedules, presenters, exhibitors, interactive maps, registration/evaluation forms and more, scan above to download the **MEGA 2024 APP!**

MEGA 2024 Committee

Alabama State Department of Education

Barry Blackwell
DaLee Chambers
Shavon Harris
Maggie Hicks
Nikkisha Hooks
Ja'Tyus Kelly
Molly Killingsworth

Angela Martin
Dawn Morrison
Nuncy Rembert
Amanda Rylant
Bonnie Short
Sean Stevens
Marcus Vandiver
Shanthia Washington

Alabama State Board of Education

Governor Kay Ivey

Jackie Zeigler

Tracie West

Stephanie Bell

Yvette M. Richardson, Ed.D.

Tonya S. Chestnut, Ed.D.

Marie Manning

Belinda McRae

Wayne Reynolds, Ed.D.

Eric G. Mackey, Ed.D.

President

District I

District II, Vice President

District III

District IV

District V, President Pro Tem

District VI

District VII

District VIII

Secretary and Executive Officer

Monday July 8

MEGA 2024 Opening Session - 1:30pm

Mobile Convention Center- East and West Ballrooms

Tuesday July 9

7:30 - 8:15am	Early Bird Session – MCC/Room 203A
8:30 - 10:00am	90-minute sessions
8:30 - 11:15am	Half-day sessions
10:15 - 11:15am	1-hour sessions
11:15am - 12:45pm	LUNCH/VISIT EXHIBITS
12:45 - 1:45pm	1-hour sessions
12:45 - 3:30pm	Half-day sessions
2:00 - 3:30pm	90-minute sessions

Wednesday July 10

7:30 - 8:15am	Early Bird Session – Riverview/Bon Secour II
8:30 - 10:00am	90-minute sessions
8:30 - 11:15am	Half-day sessions
10:15 - 11:15am	1-hour sessions
11:15am - 12:45pm	LUNCH/VISIT EXHIBITS
12:45 - 1:45pm	1-hour sessions
12:45 - 3:30pm	Half-day sessions
2:00 - 3:30pm	90-minute sessions

Thursday July 11

8:30 - 10:00am	90-minute sessions
8:30 - 11:15am	Half-day sessions
10:15 - 11:15am	1-hour sessions
11:15am - 12:45pm	LUNCH/VISIT EXHIBITS
12:45 - 1:45pm	1-hour sessions
12:45 - 3:30pm	Half-day sessions
2:00 - 3:30pm	90-minute sessions
4:30pm	BINGO!

Friday July 12

8:30 - 10:00am	90-minute sessions
8:30 - 11:15am	Half-day sessions
10:15 - 11:15am	1-hour sessions

WI-FI

Mobile Convention Center
 Network Name: Mega2024
 Password: mega2024

**Renaissance Riverview
 and Battle House**
 Network Name:
 Renaissance_Conference
 Password: mega2024

WI-FI

ALL ABOUT THE 2024

MEGA CONFERENCE

When you arrive at MEGA:

Upon arrival, participants may pick up materials at the registration desk in the Mobile Convention Center Monday through Thursday from 7:30 a.m. until 3:30 p.m. each day.

Conference App:

We encourage you to use the **conference app** with features such as the photo album, “connect” tool, “interact” feed, and session discussion tool to interact with presenters, exhibitors, and/or other attendees during the conference.

What to Wear and Bring:

Participants are invited to dress comfortably and may want to consider bringing a sweater or jacket for cooler environments, especially if sensitive to cooler temperatures. Participants should wear their name badge to all MEGA Conference sessions and events and bring their mobile device with the MEGA Conference 2024 app downloaded to it to receive credit for attending sessions.

What to Eat:

As always, breakfast and snacks will be provided for all registered attendees to enjoy in each conference venue Tuesday through Thursday. On Friday, breakfast will be provided at the Mobile Convention Center only. For lunch (on your own), there will be a variety of convenient dining options located within each of the conference venues to accommodate different dietary preferences.

- **The Mobile Convention Center** will have several food kiosks set up throughout the convention center serving items such as sandwiches, salads, soups, snacks, and drinks. Also, there will be three food trucks in the MCC exhibit hall on the first floor with a variety of options, including Caribbean-infused American Cuisine, cheesesteaks, loaded fries, wings, and tacos.
- **The Riverview Renaissance Hotel** will offer a daily southern buffet with options such as catfish, fried chicken, and pasta dishes.
- **The Battle House Hotel** will have a pop-up salad, soup, and sandwich bar and quick options at their in-house restaurant, Joe Cain’s.

Where to park:

If not staying and parking at a hotel within walking distance of the Mobile Convention Center, parking (at no cost to MEGA Conference 2024 Attendees) will be available at the Mobile Cruise Terminal, located at 201 S. Water Street. Free air-conditioned shuttle round-trip service will be provided daily at 15-minute intervals from the Cruise Terminal parking lot to the Convention Center from Monday, July 8th through Thursday, July 11th, from 7:00 a.m. to 5:00 p.m., and will conclude on Friday, July 12th at noon. Limited parking can also be found in the parking deck under the Mobile Convention Center for \$10 per day.

Shuttle Service:

In addition to shuttle service from the Mobile Cruise Terminal Parking lot to the Convention Center, free air-conditioned shuttle round-trip service will also be provided for the Battle House, Admiral, and Downtown Holiday Inn hotels with a designated waiting area. Shuttle Service will run Monday through Thursday from 7:00 a.m. to 5:00 p.m., and will conclude on Friday, July 12th at noon.

Only registered attendees can attend MEGA conference.

Due to safety and limited spacing, children are not allowed to attend MEGA sessions.

DON'T MISS THE OPENING SESSION!

Mobile Convention Center- East and West Ballrooms

Welcome

Tonya Terry



Tonya Terry

National Anthem

Loretta Crawford, Spanish Fort Middle School

Student Performance

Baldwin County High School Tigerettes

Greetings

Joe Snowden, City of Mobile

Chreasal Threadgill, Superintendent of Mobile County Schools

Dr. Eric G. Mackey, State Superintendent of Education



Dr. Eric G. Mackey

Keynote Speaker

Suzy Pepper Rollins



Suzy Pepper Rollins



Announcements

Sponsors

Door Prizes



TEACHER DIRECT
Your DIRECT SOURCE for quality educational materials at a teacher-friendly price.

1-88-Teachers (1-888-322-4377)
Fax 1-888-628-5878 | TEACHERDIRECT.COM

Check out our social media profiles for our digital content.





Literacy

Can And Should Be For All



Lexia All For Literacy

NOW AVAILABLE FOR K-5



Evidence-based phonics program aligned with the science of reading

95 Phonics Core Program®

- Tier 1 phonics program
- Meets ESSA Level 1 Evidence
- Turnkey, Structured Literacy Solution



Scan the code or visit 95pg.info/pcp to learn more.



Trusted, proven literacy solutions
95percentgroup.com | sales@95percentgroup.com | 847.499.8200
©2024 95 Percent Group LLC. All rights reserved.



Reimagine weight loss and well-being

Have a ball this summer and lose weight with Wondr™ — a digital weight-loss program — available at no cost to you.* Wondr goes beyond diet fads to teach you science-based skills so you can enjoy your favorite summer foods and activities while improving your overall health.



Visit us at our booth!

Learn more at do.wondrhealth.com/PEHP



Suzy Pepper Rollins

Suzy Pepper Rollins is a passionate educator with a mission of creating academic success for ALL learners. She is the author of *Teaching in the Fast Lane*, *Learning in the Fast Lane*, and *Teaching Vulnerable Learners*. Her new workbook, *The Promise of Acceleration*, creates a positive path for students who have gotten behind.

Suzy consults and provides PD across the nation. Prior to consulting, Suzy coordinated 6-12 remedial programs for a large Atlanta area district.

Suzy is the founder of Math in the Fast Lane, a hands-on instructional resource. She holds an M.A. in School Business Administration from Kean University.

She can be reached via her sites below or on X (@myedexpert)
www.SuzyPepperRollins.com
www.MathinFastLane.com

AE Touch Technologies
Education & Enterprise Technology Solutions

AE LCD 15" Writing Pad

This smart electronic 15" LCD Writing Pad allows your child to draw, scribble, doodle, and erase easily!

Feels just like a familiar pen, marker, chalk, and paper on a reusable, portable, paperless device that never needs to charge or plug in.

Great for toddlers, children, and moms. Use on the go in the car to keep your child's creative juices flowing and prevent boredom!

AE Interactive Flat Panels

The "AETouch" is our own brand of interactive flat panels designed with education and enterprise in mind. Our panel sizes range from 43" to 110".

AE LCD 8.5" Writing Pad

Colorful 8.5" drawing pad uses the newest LCD pressure-sensitive technology and comes in three different animal patterns!

Our LCD Writing Pad has no radiation or glare and can be erased and written on over 100,000 times!

AE EZ LED Standing Panels

Run Movies or Advertisements at your convenience on a single AE EZ LED Panel or connect all 5 to make it a JUMBO SCREEN!

Adam Crappel
President & CEO
adam@aetouch.com

Connect With Us Today!
855-997-0199
 1005 Clothilde St
 Morgan City, LA 70380
www.aetouch.com



Trust the Standards Experts

Your All-Inclusive Print & Digital Solution in ELA & Math



REQUEST YOUR FREE BOOK!

alabama.abck12.com/request



OUR PROGRAM

★ Tools for You

ACAP Success Workbooks include free eBooks, Online Testing administration, scoring, and data report features, plus Teacher's guides!

★ Data-Driven Instruction

Built-in analytics, mapped to current AL Course of Study standards, help you provide data-driven instruction customized to your students' needs.

★ Score-Improvement Guarantee

Our guarantee provides your score improvements - Risk Free!
Contact us for more details.

CONTACT US

888.264.5877

alabama@abck12.com

americanbookcompany.com/alabama

ABOUT US

American Book Company's All-Inclusive Print & Digital resources cover 100% of the Alabama Course of Study standards in preparation for ACAP assessments.

ALL-INCLUSIVE

Every ABC Resource includes:

- Student Workbook
- eBook
- CourseWave Online Testing

Experience the Difference *Online*

Experience Columbia Southern University

For more than 25 years, Columbia Southern University has been a leader in online education. Our degree programs prepare you for today's fastest-growing career fields, in a proven online format that fits your learning style and your lifestyle.



Award winning courses*



Rich, interactive learning format



Industry expert faculty



Tuition at half the cost of other universities

Columbia Southern University is a four-time Blackboard, Inc., Exemplary Course Program Award winner and has 45 Quality Matters designated courses.



Take Advantage of Your Learning Partner Tuition Discount and Access to Exclusive Scholarships

Visit ColumbiaSouthern.edu
or call 877.347.6050.



Always Forward. Always Online.



Alabama Institute for Deaf and Blind is the world's most comprehensive education, rehabilitation and service program serving individuals of all ages who are Deaf, Blind, DeafBlind and multidisabled.

Founded in 1858, AIDB now serves more than 32,000 infants, toddlers, children, adults and seniors with hearing and vision loss throughout Alabama each year.

For more information visit www.AIDB.org.

WI-FI

Mobile Convention Center

Network Name: Mega2024

Password: mega2024

Renaissance Riverview and Battle House

Network Name:

Renasissance_Conference

Password: mega2024

WI-FI



The UWA Black Belt STEM Education Institute is dedicated to cultivating critical thinking, problem-solving skills, and a passion for lifelong learning through inquiry, place based learning opportunities, high-quality professional development, student activities, and community and industry partnerships.



www.uwa.edu/black-belt-stem-institute

WELCOME TO MEGA 2024!



**COLLEGE ADMISSIONS
MADE POSSIBLE**



Dr. Michelle Hayes
Executive Director

**EMPOWERING STUDENTS
BY EQUIPPING THEM WITH
THE ESSENTIAL TOOLS TO
GAIN ACCESS TO COLLEGE,
UNIVERSITY, OR CAREER
OF THEIR CHOICE.**

Founded in 2011 by Dr. Martin Nalls, College Admissions Made Possible (CAMP) provides intensive college admissions assistance to low-income and minority high school students. CAMP is the go-to organization for professional services dedicated to assisting high school students with the sometimes-daunting process of college selection, application completion, scholarship search, and so many other tasks that have to be tended to for a successful outcome.

5529 1st Avenue
Birmingham, AL 35212
(205) 305-4666
mhayes@campcollege.org

WWW.CAMP COLLEGE.ORG

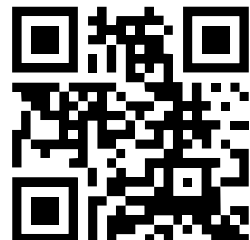



Meet Emari, a star student in the Alabama First Class Pre-K program at the Greater Birmingham Northeast YMCA, proudly supported by the Alabama Power Foundation. Emari loves math puzzles, pizza and orange cars. According to his teachers, Emari experienced exceptional growth in First Class Pre-K, finishing pre-K ready for “big school” and excelling in elementary school due to a strong grasp of foundational concepts.

The Alabama Power Foundation is proud to support educators and initiatives that help students become more intelligent, engaged and prepared for their futures.

Since 2018, we’ve awarded \$10 million through over 1,300 grants to build and sustain educational programs from pre-K to 12th grade. We’re excited to support students like Emari as they grow and take on life. With a strong educational foundation, we can break down barriers and power a better Alabama for generations. Learn more at [PowerOfGood.com](https://www.PowerOfGood.com).



Leading today, impacting tomorrow.

In-person and online programs: specialist, master's and doctorate.
AL educators qualify for the **Educator Excellence Scholarship.**



Comprehensive Services

Bailey Education Group is a regional leader in comprehensive school improvement services. We offer customized coaching and development in the following areas:

- ACT Support
- CCEIS Support
- Classroom Management & Behavioral Support
- Counselor Support
- Cultural Diversity
- Curriculum Development & Support
- Data Analysis
- Early Childhood
- English Language Arts
- English Learners
- Federal Programs
- Instructional Audit
- Instructional Technology & Learning Management Systems
- Leadership Development
- Mathematics
- Multi-Tiered Systems of Support
- Positive Behavior Interventions & Supports
- Science
- Social Studies
- Social Emotional Learning
- Special Education

We also offer direct student support services in the following areas:
ACT, ACT WorkKeys, Math, ELA, Science, History, and EL.



CONTACT US



DMT INSTITUTE

Developing Mathematical Thinking Institute (DMTI)



Professional
Development



Curricular
Resources



Assessment

Jonathan Brendefur, PhD
jonathan@dmtinstitute.com

 © DMTI (2019) | RESOURCE MATERIALS | WWW.DMTINSTITUTE.COM



Teaching Strategies®

New!

The Creative Curriculum® for Pre-K

Provide meaningful, individualized learning experiences for all children, including those with disabilities.



Come visit our booth to learn more!



Vital
Improving Wellness in Alabama

**ENGAGEMENT •
COLLABORATION • EDUCATION**

VITALALABAMA.COM

FOLLOW US ON SOCIAL MEDIA!



@VitALabama

GAME-BASED LEARNING

FOR THE SCIENCE CLASSROOM WITH PLASMA GAMES

Attend our presentation on **Friday, July 12th** at **10:15 AM** in **Riverview & Jubilee**



Accessible Content for ALL

Solutions for Success



PERFECTION LEARNING®

AMSCO

Measuring Up

PerfectionLearning.com | (800) 831-4190



CONTACT YOUR REPI!



“If you’re looking for something to improve your math, if you’re looking for something that’s going to make a difference in either your students or in the way your teachers teach, then **Afterschool Labs is the way.**”

PATRICE MAXWELL
Gadsden City Schools | Principal



- ✓ Total Program Management
- ✓ Teacher Growth + Retention
- ✓ Sole-Proprietary Curriculum
- ✓ Teacher-Led Small Groups
- ✓ Flexible Funding Options



Scan to learn more.



Afterschool Labs

ACCELERATING STUDENT RECOVERY + ACHIEVEMENT

✉ info@helloafterschool.com 🌐 helloafterschool.com

Mobile Convention Center

Upper Level

MEGA 2024 OPENING SESSION
 EAST AND WEST BALLROOMS
 MONDAY, JULY 8 • 1:30 PM



WI-FI

Mobile Convention Center
 Network Name: Mega2024
 Password: mega2024

Renaissance Riverview and Battle House
 Network Name: Renaissance_Conference
 Password: mega2024

WI-FI

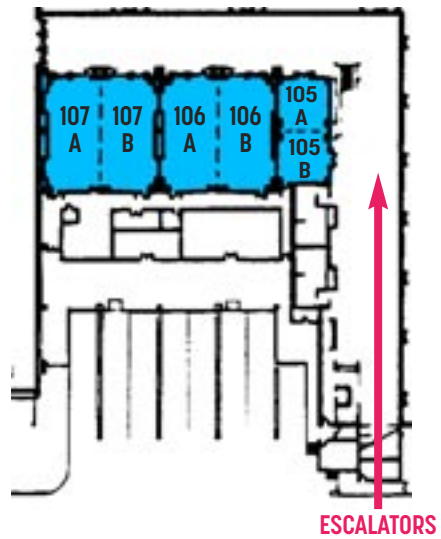

Lower Level

Renaissance Riverview Plaza Hotel

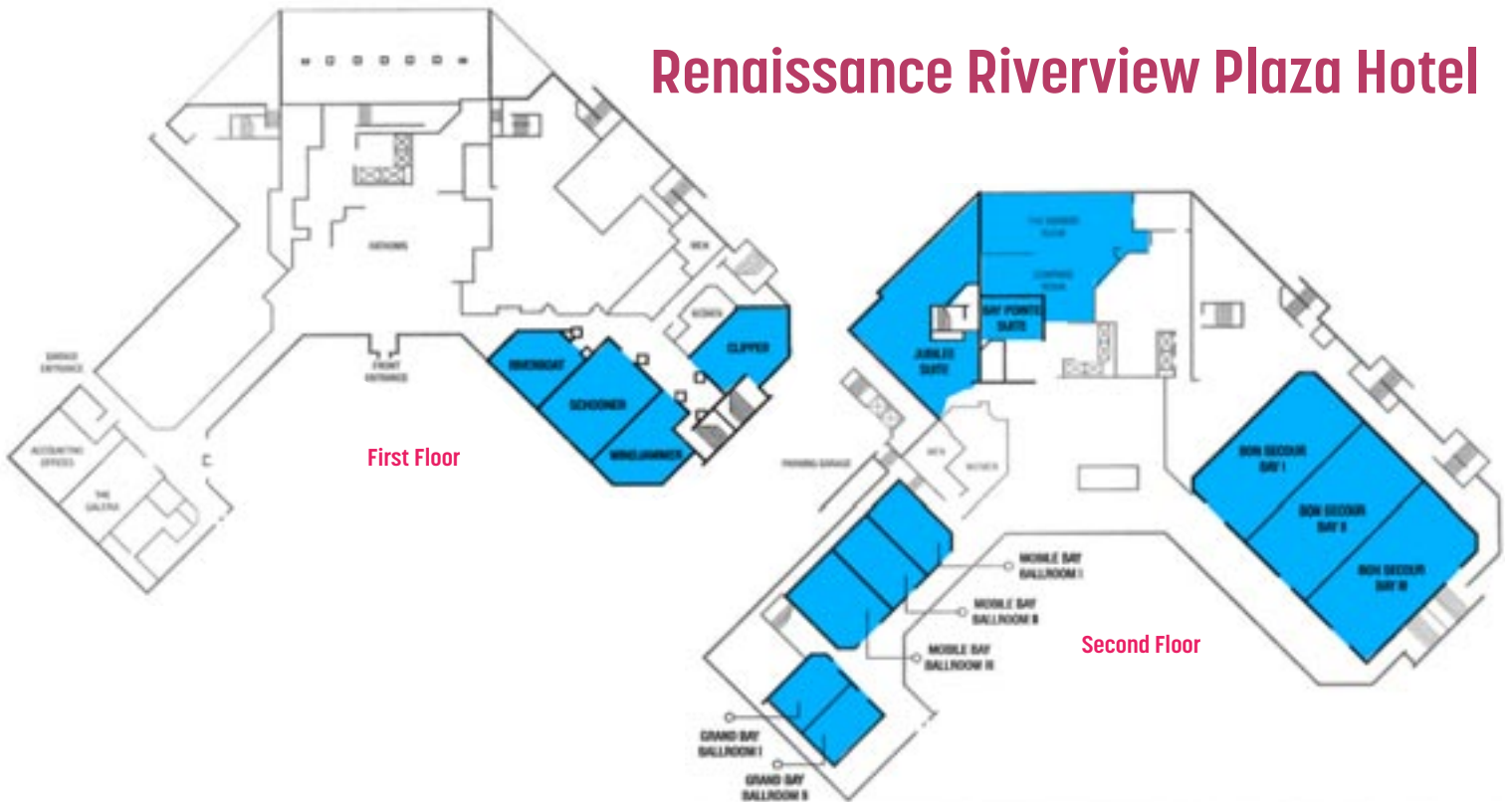

Renaissance Battle House Hotel

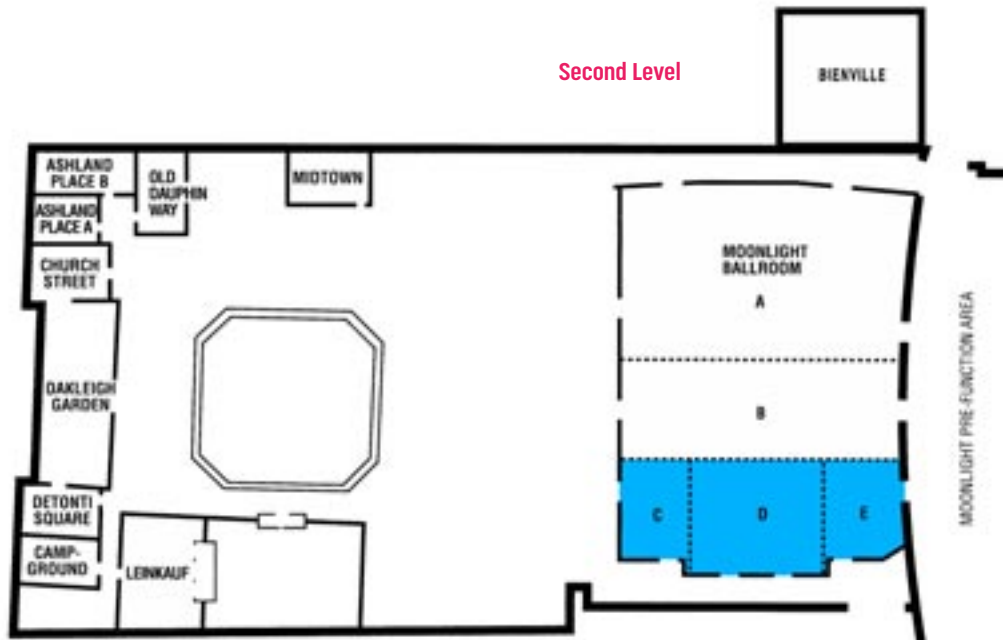



One **healthy** habit can lead to a **happier** you

Feeling your best starts with doing just one healthy thing today. Blue Cross and Blue Shield of Alabama can help you get started with easy-to-use resources and access to the largest network of doctors in the state.

Learn more about how we can help you feel your best at AlabamaBlue.com/Happy.

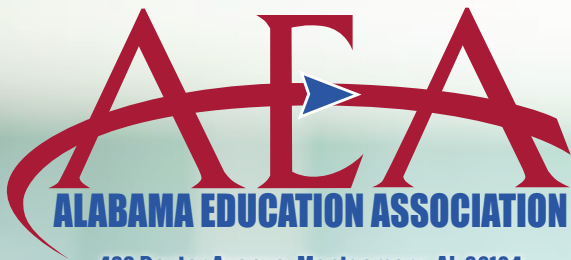

422 Dexter Avenue, Montgomery, AL 36104
VISIT: myAEA.org - EMAIL: myAEA@alaedu.org
CALL: 800.392.5839

Join the largest professional organization for educators in the state of Alabama today!



Text JOINAEA to 52886 or scan the QR code!



Earn Your Ed.D. Now!

Have you ever considered advancing your career with a Doctor of Education? Now is the time! AUM is now accepting applications.

With this 100% online program, with concentrations in Instructional Technology & Early Childhood Education, you can choose today to start moving forward!



SCAN QR CODE

A U N I V E R S I T Y I N M O T I O N

KIDS are our passion and the fuel for our work.



Our name is our mission, and our mission fuels our vision of placing
KIDS FIRST.

To learn more, reach out to our AL State Director, Reeda Betts at reedabetts@kidsfirst.llc or visit our website at kidsfirst.llc.



Accessible Content for ALL

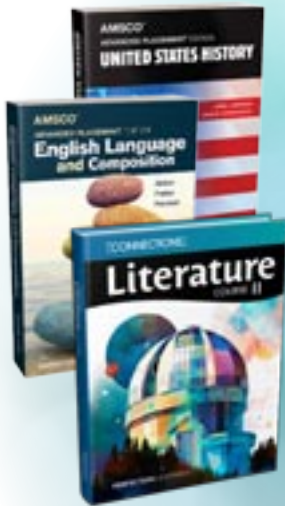

Solutions for Success



PERFECTION LEARNING®

AMSCO measuring Up

PerfectionLearning.com | (800) 831-4190



CONTACT YOUR REP!

Public Consulting Group

Making a positive impact for Alabama Education with Comprehensive Professional Development, Coaching and Supports

Available Trainings Include:

PowerSchool Number

Alternate Achievement Standards Playbook	#310389
High Leverage Practices Playbook	#302504
Inclusive Practices	#311638
Developing Strong Literacy Skills Grade 4-8	#306194
Effective Math Teaching Practices for Teachers of Grades K-8	#306403
Special Education Playbook	#302505
Successful Transitions: Putting It All Together	#314331
Transition Playbook (Student Curriculum)	n/a

Scan the QR code to find resources and register



www.alabamases.com

All MEGA Conference sessions will be held in the **Mobile Convention Center**, the **Renaissance Riverview**, the **Renaissance Battle House**, and the **Hampton Inn**.

MONDAY JULY 8

9:00 AM - 11:00 AM

Riverview

- 1515 Pre-Conference Session: Unlocking Potential: Keys to Cultivating Success Beyond Graduation *Bon Secour I*
- 1516 Pre-Conference Session: Kareem Weaver, The Right to Read *Bon Secour III*

OPENING SESSION - 1:30PM MCC EAST & WEST BALLROOMS

TUESDAY JULY 9

7:30 AM - 8:15 AM

Mobile Convention Center

- 1517 Early Bird Session: Preparing for the Fiscal Cliff *Room 203A*

8:30 AM - 3:30 PM

Mobile Convention Center

- 944 Statewide Opening to the Esteemed Black Belt Instructional Leadership Cohort Year 1, Cohort 2 *Room 204B*

Riverview

- 744 Federal Programs General Session *Bon Secour I*

8:30 AM - 10:00 AM

Battle House

- 842 Smartening Up Smarty Pants: AI Adventures with Gifted teachers and students! *Bienville Square*
- 793 Career and Technical Education Certification Updates *Crystal Ballroom*
- 926 Building our Families and Communities from Within *Moonlight CDE*
- 1095 It's Me, Hi, I'm the Least Restrictive Environment to Consider and Follow the Continuum *Treehouse*
- 1132 The Blueprint: The Compliance Verification Form (CVF) *Moonlight A*
- 1048 Activate ACT WorkKeys and WorkKeys Curriculum in Your Schools *Moonlight B*

Hampton Inn

- 864 Creating a Culture of Thinking in Gifted Classrooms: Evidence-Based Strategies That Work! *Hampton Inn*

Mobile Convention Center

- 1481 **FEATURED SPEAKER:** I Need a Boost *West Ballroom*
- 812 Handwriting: Unexpected Connections *Room 105*
- 858 We've Made the Shift to Reading Science... Now What? Supporting a Schoolwide System for Literacy: Structure Generates Behavior. Part 1 *Room 106A*
- 997 ALSDE Preschool Updates *Room 106B*
- 1460 Cultivating a Positive School Culture *Room 107A*
- 724 It's More than Child's Play: The Consequences of Bullying *Room 107B*
- 743 English Learner Updates *Room 201A*
- 788 Instructional Innovation Showcase: Climbing the Proficiency Scale Ladder to Achieve Success! *Room 201B*
- 730 ALSDE School Counseling and Guidance Updates *Room 201C*
- 893 RoboRevolution: Unleashing the Potential of Student Engagement with Robotics *Room 201D*
- 1114 Career Exploration at the Elementary Level *Room 202B*
- 1063 TransformEDucation: Powering Up High Schools for Future Success! *Room 203A*
- 814 Mindset Matters: Three Simple Steps to Improve Equity and Accuracy in Grading *Room 203B*

WI-FI

Mobile Convention Center
 Network Name: Mega2024
 Password: mega2024

**Renaissance Riverview
 and Battle House**
 Network Name:
 Renaissance_Conference
 Password: mega2024

WI-FI

All MEGA Conference sessions will be held in the **Mobile Convention Center**, the **Renaissance Riverview**, the **Renaissance Battle House**, and the **Hampton Inn**.

TUESDAY JULY 9

8:30 AM - 10:00 AM

- 908 Got Problems? We Have Solutions! *Room 204A*
- 768 Clippers & Cops Campus Invasion *East Ballroom*

Riverview

- 1103 Recognizing Innovation in Education Through Cognia's STEM Certification Process *Bon Secour III*
- 1350 Introduction to Math Nation *Clipper*
- 1291 Microsoft Accessibility Tools and Assistive Technology *Grand Bay*
- 1341 Preparing Students with Disabilities for Transition: Explicitly Addressing Transportation Needs and Supports *Jubilee*
- 895 ALERT! System Error: Intervention Overload!! Evidence Based Practices: Systematic Instruction and Multimodal (Assessment, Feedback, & Mathematical Language) *Mobile Bay*
- 726 The Nuts and Bolts of AMSTI Science and Literacy Integration *Riverboat*
- 953 How to Use ACAP Summative Performance Level Descriptors to Inform Instruction for English Language Arts *Schooner*
- 1352 Sensemaking in the Elementary Classroom *Windjammer*

8:30 AM - 11:15 AM

Mobile Convention Center

- 930 Constructing Tomorrow: A Hands-On Workshop for Elementary Educators in Robotics Integration and Creative Construction *Room 202A*

10:15 AM - 11:15 AM

Battle House

- 727 Unlocking Affective Learning Using the Gifted Standards and Student Outcomes *Bienville Square*
- 1405 Ensuring Wellness: A Comprehensive Approach to Threat Assessment and Crisis Response in Education *Crystal Ballroom*
- 967 Alabama MTSS Superintendent Panel : Unlocking the Potential of MTSS *Moonlight CDE*
- 1158 Differentiated Instructional Guide (DIG), Annual Goals, and Progress Monitoring *Treehouse*
- 1001 The Measuring Tape: Elements of the Present Level of Academic Achievement/Functional Performance *Moonlight A*
- 943 Through the Lens of a 6-12 Math Educator: Let's Focus on the ACT! *Moonlight B*

Hampton Inn

- 1017 Classroom Organization Management Program C.O.M.P Overview *Hampton Inn*

Mobile Convention Center

- 1367 Harnessing Social-Emotional Learning for Safe Learning Environments *West Ballroom*
- 815 Spelling: The Superpower Behind Every Good Reader *Room 105*
- 859 How Do We Wrap Around the Needs of Kids? Supporting a Schoolwide System for Literacy: Structure Generates Behavior Part 2 *Room 106A*
- 1185 Charting the Path for LEA Charter Authorizers *Room 106B*
- 1458 Increase Student Motivation and Ownership Through the Use of Proficiency Scales and Standards-Based Grading *Room 107A*
- 1454 Write Away: Building a Sustainable Thinking and Writing Classroom *Room 107B*
- 850 Alabama Literacy Act and English Learners *Room 201A*
- 803 Building Assessments Based on Proficiency Scales *Room 201B*
- 769 A Beautiful Balancing Act: The Art of Running a Comprehensive School Counseling Program in an Elementary Setting *Room 201C*
- 874 Using Data and Supports for Students in Virtual Learning *Room 201D*
- 1192 Updates From the Office of Career Technical Education and Workforce Development *Room 202B*
- 1310 Unveiling the Future: Harnessing STEM Excellence Through Robotics Education (Alabama South BEST Robotics) *Room 203A*
- 731 Cohort Collaboration: Huntsville City Schools' Transformative Initiative for School Improvement and Strategic Turnaround *Room 203B*
- 839 New Kids on the Block- Meet the Literacy Specialists Supporting Grades 4-12! *Room 204A*
- 742 Suicide Prevention 201: What to do After an Attempt *East Ballroom*

All MEGA Conference sessions will be held in the **Mobile Convention Center**, the **Renaissance Riverview**, the **Renaissance Battle House**, and the **Hampton Inn**.

TUESDAY JULY 9

10:15 AM - 11:15 AM

Riverview

- 1474 Alabama ABLE Savings Plan - A Savings Tool for Individuals with Disabilities *Captain*
- 1500 Empowering Students for Post-Secondary Success *Commodore*
- 804 Accelerating Learner Growth: The Students That Could *Bon Secour III*
- 1343 The Language of Math - What We Say Matters *Clipper*
- 898 iWonder: iPad Access for Students with Physical, Sensory, and Learning Challenges *Grand Bay*
- 1316 Purple Star Schools! What is Beyond the Horizon? *Jubilee*
- 863 Math Game On! *Mobile Bay*
- 1032 Empowering Educators: Cultivating Teacher Confidence through Communities of Practice *Riverboat*
- 1059 ACAP Summative Reading Items Subset *Schooner*
- 1351 FOSS Meets the Science of Reading *Windjammer*

12:45 PM - 1:45 PM

Battle House

- 866 Differentiating Instruction for Gifted Students: Strategies That Work! Bienville Square
- 876 Registered Teacher Apprenticeship Pilot Program Overview *Crystal Ballroom*
- 984 2023 Alabama Course of Study: Science *Moonlight CDE*
- 1010 The Sander: Shaping Young Minds Through Specially Designed Instruction *Moonlight A*
- 868 I Read It, But I Don't Get It: Strategies to Improve Analytical Reading: Grades 6-12 *Moonlight B*

Hampton Inn

- 1018 WIN Back Your Instructional Time with Learning Centers in High School! *Hampton Inn*

Mobile Convention Center

- 1464 PEEHIP Health Insurance: Coverage for Career & Retirement *West Ballroom*
- 834 Word Nerds: Developing Complex Vocabulary Across the Curriculum *Room 105*
- 822 Alabama Literacy Act: Prevention, Retention...Now What? *Room 106A*
- 1440 Diversifying and Differentiating: Inclusion Strategies for Gifted Students in Gen Ed *Room 107A*
- 1401 The Coach's Playbook: Using Choice Boards for Professional Development and Coaching Cycles *Room 107B*
- 848 Understanding Specific Challenges and Difficulties for English Learners *Room 201A*
- 855 Alabama Seal of Biliteracy *Room 201B*
- 758 Mastering FAFSA: Your Guide to Completing the New FAFSA and Increasing FAFSA Completion Rates *Room 201C*
- 904 Classroom Management and Community Building: Secondary Edition *Room 201D*
- 1336 Charting the Path for LEA Charter Authorizers (Repeat Session) *Room 202B*
- 1081 Boosting Literacy Skills Through Vocabulary Instruction *Room 203B*
- 1270 Artificial Intelligence (AI) - Explore Innovative Magical Machines: The Foundations, Use, and Creative Power! *Room 204A*
- 965 **FEATURED SPEAKER:** Fun Weird Science: STEM-Based Lesson Hooks *East Ballroom*
- 1514 **FEATURED SPEAKER:** Sowing Seeds of Educational Success: Growing Exemplary Teachers *Room 106B*

Riverview

- 1502 Alabama ABLE Savings Plan - A Savings Tool for Individuals with Disabilities (Repeat Session) *Captain*
- 1508 Empowering Students for Post-Secondary Success (Repeat Session) *Commodore*
- 1159 Accelerating Learner Growth: The Students That Could (Repeat Session) *Bon Secour III*
- 1309 "Seeing" the Math: Developing Conceptual Understanding with Brain Research *Clipper*
- 1155 iWonder: iPad Access for Students with Physical, Sensory, and Learning Challenges (Repeat Session) *Grand Bay*
- 1315 Virtual Reality 101: Solving Real World Problems in a Virtual World *Jubilee*
- 1379 Middle School Data Can Move *Riverboat*

WI-FI

Mobile Convention Center
Network Name: Mega2024
Password: mega2024

**Renaissance Riverview
and Battle House**
Network Name:
Renaissance_Conference
Password: mega2024

WI-FI

All MEGA Conference sessions will be held in the [Mobile Convention Center](#), the [Renaissance Riverview](#), the [Renaissance Battle House](#), and the [Hampton Inn](#).

TUESDAY JULY 9

12:45 PM - 1:45 PM

- 870 ACCESS for ELLs - Let's Move It! *Schooner*
- 1233 Step 2 Adulthood - Transitioning to Adulthood with Exceptional Learners (Ages 18-21) *Windjammer*
- 1503 Understanding the School Principal Leadership and Mentoring Act (Repeat Session) *Mobile Bay*

12:45 PM - 3:30 PM

Battle House

- 1072 Transition: A Journey of Discovery *Treehouse*

Mobile Convention Center

- 929 Leading the Charge: Unlocking the Potential for Student Success on the ACT *Room 203A*
- 928 Coding Carousel: A Carnival of Computer Science and Robotics Integration for Elementary Educators *Room 202A*

2:00 PM - 3:30 PM

Battle House

- 897 Merging Math and Art to Foster STEM Creativity *Bienville Square*
- 792 Understanding Certification Data: An Overview of INS and OUTS *Crystal Ballroom*
- 942 The Key to Educator Wellness: Struggling Well Together Creates Well-Being for All *Moonlight CDE*
- 1086 The Level: Effective Practices in Secondary Transition and the Individualized Education Program (IEP) *Moonlight A*
- 867 Make Learning Come Alive! *Moonlight B*

Mobile Convention Center

- 878 Mastering the Onboarding Journey with Our New Applicant Tracking System *West Ballroom*
- 958 Using Sound Walls to Support and Advance Instruction *Room 105*
- 960 ACAP Summative and the ALA: The Keys to Unlocking Proficiency and Securing Sufficiency *Room 106A*
- 1504 Understanding the School Principal Leadership and Mentoring Act (Repeat Session) *Room 106B*
- 751 Alabama's Accountability Systems *Room 107A*
- 1015 The School Psych Way *Room 107B*
- 856 Keys to Success: Unlocking the Potential of Secondary English Learners *Room 201A*
- 1054 Primary Sources in Primary Grades? YES, YOU CAN! *Room 201B*
- 729 ALSDE Curriculum and Instruction Updates *Room 201C*
- 725 Alabama Learning Exchange: Create. Collaborate. Educate. *Room 201D*
- 1296 Empowering Early Career Exploration with the Alabama Career Planning System *Room 202B*
- 979 Build Back Better! *Room 203B*
- 919 Let's Start a Revolution...A Writing Revolution, That Is! *Room 204A*
- 762 QPR-Question, Persuade, and Refer--Ask A Question, Save A Life (CPR for a Mental Health Crisis)! Everyone Plays a Role! *East Ballroom*
- 1519 **FEATURED SPEAKER:** Sowing Seeds of Educational Success: Growing Exemplary Teachers *Room 106B*

Riverview

- 817 Making Differentiation Doable for Leaders *Bon Secour III*
- 1023 The Organized Leader: Mastering Digital Organization and Effective Communication *Clipper*
- 1294 Exploring the Role of Artificial Intelligence as Assistive Technology *Grand Bay*
- 1419 Dothan City Putting Kids First: A Helping Hands Partnership to Building a Culture of Support *Jubilee*
- 1026 The Elementary Math Tier 3 Intervention Experience *Mobile Bay*
- 1061 Teaching Among the Stars: A Cosmic Exploration of Integrating ACT Success Strategies with ATOT - Aligned Teaching Behaviors *Schooner*
- 1194 IEP Minutes That Matter: Quick-Fire Strategies and Tools for Busy Special Ed Teams *Windjammer*

Hampton Inn

- 1463 Teacher's Retirement System & RSA-1: Setting the Financial Foundation for Retirement *Hampton Inn*

All MEGA Conference sessions will be held in the **Mobile Convention Center**, the **Renaissance Riverview**, the **Renaissance Battle House**, and the **Hampton Inn**.

WEDNESDAY JULY 10

7:30 AM - 8:15 AM

Riverview

1518 Early Bird Session: An Open Discussion with the ALSDE Executive Team *Bon Secour III*

8:30 AM - 3:30 PM

Battle House

865 Torrance Tests of Creative Thinking-Figural: Administration, Scoring, and Interpretation *Bienville Square*

8:30 AM - 10:00 AM

Battle House

877 Navigate to Success: New Applicant Tracking System Training *Crystal Ballroom*

1066 Beyond the Report Card: Equipping Students for Real-World Success *Treehouse*

Hampton Inn

903 Purposeful Podcasting to Elevate Student Voice *Hampton Inn*

Mobile Convention Center

794 The Alabama Teacher Mentor Program *West Ballroom*

1000 Spotlighting the Science of Reading: Shining a Light on District Structures and Supports *Room 105*

1118 We've Made the Shift to Reading Science ... Now What? Supporting a Schoolwide System for Literacy: Structure Generates Behavior. Part 1 (Repeat Session) *Room 106A*

894 Educating Students with Disabilities: Frequently Asked Questions about Section 504 FAPE *Room 106B*

1437 Curriculum Mapping, Standards Based Learning and Grading in ELA and SS *Room 107A*

920 The Emotional Bridge to Academic Success *Room 107B*

1078 Job Shadowing: How to Plan a Successful Job Shadowing Event *Room 201A*

1068 What About the Adults in the Building? Strengthening Adult Foundational Wellness is Key! *Room 201B*

849 Best Practices for Supporting English Learners in Your School Counseling Program *Room 201C*

735 Growing a Sustainable Future: Alabama Green Ribbon Schools *Room 201D*

720 Improving Outcomes for Students with the Academy of Craft Training: A Private-Public Partnership *Room 202B*

1030 Beyond Comfort Zones: Unleashing Potential via Productive Struggle *Room 203A*

733 Not Another Boring Data Meeting: Roadmap for School Improvement Through Intentional Use of Data *Room 203B*

1062 I Will Always Love...ACIPs (The Remix) *Room 204A*

975 Reimagining Classroom Management While Resetting Schoolwide Expectations *Room 204B*

871 Alabama Coordinated School Nurses Updates *East Ballroom*

906 Take Flight with Drones in Education (Secondary) *Room 202A*

Riverview

1220 Nurturing Resilience for Success in School and Beyond *Admiral*

1230 Teacher Math Anxiety: Understanding its Effects in the Classroom and Implications for Administrators *Captain*

1489 Immersive Learning through Augmented Reality *Commander*

746 21st Century Community Learning Centers (CCLC) Guidance for the Grant Application Process *Commodore*

1258 PowerSchool Student Plans (Unified Insights) *Bon Secour I*

1039 Understanding the School Principal Leadership and Mentoring Act *Bon Secour II*

1160 Making Differentiation Doable for Leaders (Repeat Session) *Bon Secour III*

1176 A Cyclical Framework of Maximizing Title II Funds (Repeat Session) *Clipper*

1236 BREATHE -Burnout Reduction: Enhanced Awareness, Technology, Handouts, Empowerment *Grand Bay*

WI-FI

Mobile Convention Center

Network Name: Mega2024
Password: mega2024

Renaissance Riverview and Battle House

Network Name:
Renaissance_Conference
Password: mega2024

WI-FI

All MEGA Conference sessions will be held in the **Mobile Convention Center**, the **Renaissance Riverview**, the **Renaissance Battle House**, and the **Hampton Inn**.

WEDNESDAY JULY 10

8:30 AM - 10:00 AM

- 778 Connecting the Data: Planning for School Improvement *Jubilee*
- 1141 The Nuts and Bolts of AMSTI Science and Literacy Integration (Repeat Session) *Riverboat*
- 954 How to Use ACAP Summative Performance Level Descriptors to Inform Instruction for Math *Schooner*
- 1453 Helping Our English Learners Succeed *Windjammer*

8:30 AM - 11:15 AM

Battle House

- 1368 Bridging Reliable Relationships with Students, Parents and the Community through BARR *Leinkauf*
- 1152 Special Education Services (SES) Updates *Moonlight ABCDE*

10:15 AM - 11:15 AM

Battle House

- 795 Educator Testing 101: An Overview of Current Test Requirements for Educators and Strategies for Success *Crystal Ballroom*
- 1022 Project-Based Learning: Strategies to Increase Student Engagement While Developing Social-Emotional Skills *Treehouse*

Hampton Inn

- 902 Demystifying Assistive Technology *Hampton Inn*

Mobile Convention Center

- 1514 **FEATURED SPEAKER:** Sowing Seeds of Educational Success: Growing Exemplary Teachers *West Ballroom*
- 1119 Word Nerds: Developing Complex Vocabulary Across the Curriculum (Repeat Session) *Room 105*
- 1120 How Do We Wrap Around the Needs of Kids? Supporting a Schoolwide System for Literacy: Structure Generates Behavior. Part 2 (Repeat Session) *Room 106A*
- 1083 Workplace Solutions: Connecting Professional Service with Personal Sacrifice *Room 106B*
- 888 Alabama's Accountability Systems: Calculations, Calculations, Calculations *Room 107A*
- 1111 Specialized Treatment Centers (STCs): Providing Support, Defining Lines, and Building Connections *Room 107B*
- 854 Empowering Mathematics Instruction for English Learners *Room 201A*
- 771 Preparing for the Ethical and Legal Implications of Working with Students: Professional Practice and Decision-Making *Room 201C*
- 721 Fostering Excellence: Designing Quality Physical Education Programs *Room 201D*
- 1223 Preparing Alabama's Workforce: The ACE Program for High School Students *Room 202B*
- 1292 Social Media..What Our Kids Know and What We Don't *Room 203A*
- 1268 Engaging Minds: Implementing Project-Based Learning in Middle and High Schools *Room 203B*
- 1052 Meeting Requirements and Enhancing Performance: Leveraging ATOT Data for ACIP Development *Room 204A*
- 1248 Social Emotional Learning Strategies for Administrators and Teachers *Room 204B*
- 1425 The Importance of School Nurses and School Personnel in Tobacco Prevention *East Ballroom*
- 936 Cultivating Innovators: A Workshop for Administrators on Fostering Career-Ready Skills through Computer Science Integration *Room 202A*

Riverview

- 1211 We're All in This Together! Creating a Culture in Which Everyone Feels Heard, Valued, and Supported *Admiral*
- 1153 Empowering Alabama's Educators: Enhancing Data Literacy for Students who are College, Career, and Workforce Ready *Captain*
- 1488 Engaging Early Learners *Commander*
- 1501 Enhancing Accountability Through Student-Led Progress Tracking and Communication *Commodore*
- 1254 PowerSchool Unified Insights (Student Analytics) *Bon Secour I*
- 977 Unleashing the Power of Possibility *Bon Secour II*
- 808 Technical Support for State-Mandated Training in the Learning Community Platform *Bon Secour III*
- 772 Homeless Education: McKinney-Vento Eligibility *Clipper*
- 946 Add Art to Math to Enhance Understanding K-2 *Grand Bay*

WI-FI

Mobile Convention Center
Network Name: Mega2024
Password: mega2024

Renaissance Riverview and Battle House

Network Name:
Renaissance_Conference
Password: mega2024

WI-FI



American Book Company



All MEGA Conference sessions will be held in the **Mobile Convention Center**, the **Renaissance Riverview**, the **Renaissance Battle House**, and the **Hampton Inn**.

WEDNESDAY JULY 10

10:15 AM - 11:15 AM

- 753 Equitable Services for Private Schools *Jubilee*
- 995 PD on the Go: Implementing Professional Development in a Box *Mobile Bay*
- 1142 **FEATURED SPEAKER:** Fun Weird Science: STEM-Based Lesson Hooks (Repeat Session) *Riverboat*
- 948 Through the Lens of ALL 6-12 Educators: Let's Focus on Writing and the ACT! *Schooner*
- 1365 BigFuture: Guiding All Students to Own Their Future *Windjammer*

12:45 PM - 1:45 PM

Battle House

- 1242 ANA and Coaches and Data, OH MY! *Crystal Ballroom*
- 1157 Beyond the Report Card: Equipping Students for Real-World Success (Repeat Session) *Treehouse*

Mobile Convention Center

- 1519 **FEATURED SPEAKER:** Sowing Seeds of Educational Success: Growing Exemplary Teachers (Repeat Session) *West Ballroom*
- 1121 Spelling: The Superpower Behind Every Good Reader (Repeat Session) *Room 105*
- 1122 Alabama Literacy Act: Prevention, Retention...Now What? (Repeat Session) *Room 106A*
- 1149 Educating Students with Disabilities: Frequently Asked Questions About Section 504 FAPE (Repeat Session) *Room 106B*
- 1394 Standard Operating Procedures: Master Keys to Proficiency in Multiple Content Areas *Room 107A*
- 1150 Specialized Treatment Centers (STCs): Providing Support, Defining Lines, and Building Connections (Repeat Session) *Room 107B*
- 853 Ellevation Updates for 2024-2025 *Room 201A*
- 755 How to Begin an Afterschool Recreational Program for Your School System. Anyone Can Do It! *Room 201B*
- 774 Principal and School Counselor Partnerships: Aligning Leadership Roles to Support the School Mission and Student Success *Room 201C*
- 950 Understanding Student Behavior is the First Step to Supporting It *Room 201D*
- 1217 The ASVAB Career Exploration Program (CEP) Empowers Students to Make Informed Decisions *Room 202B*
- 1225 Breaking Barriers: A Pathway to Success with the Non-Traditional High School Diploma Option (HSDO) Program *Room 203B*
- 1085 Emerging, Proficient, Mastery - Three Words that Intrinsically Motivate and Drive Instruction *Room 204A*
- 1024 Questioning and Feedback to Deepen the Learning of All: Two Schools' Journeys *Room 204B*
- 1046 Alabama Teacher Growth Program (ATGP) and Alabama Teacher Observation Tool (ATOT)—A Refresher Session *East Ballroom*
- 890 Convert Static Worksheets into Interactive, Digital, Self-Grading Assignments *Room 202A*

Riverview

- 1491 Building Educator Capacity *Commander*
- 1509 Enhancing Accountability Through Student-Led Progress Tracking and Communication (Repeat Session) *Commodore*
- 749 Title I-A Overview *Bon Secour I*
- 1426 Building Collective Efficacy Through Peer Coaching *Bon Secour II*
- 1161 Technical Support for State-Mandated Training in the Learning Community Platform (Repeat Session) *Bon Secour III*
- 1012 Roundabouts on Reality: How do We Utilize Data Sources to Inform Teaching and Learning Decisions? *Clipper*
- 1034 Elementary, My Dear: Detect Beliefs that Impact K-5 Student Growth *Grand Bay*
- 760 A Cyclical Framework of Maximizing Title II Funds *Jubilee*
- 773 Overcoming Challenges: Creating an Atmosphere for Change (The Multi-faceted Role Leaders Play in Developing Mathematical Proficiency) *Mobile Bay*
- 1297 Math Interventions: Developing Understanding of Number and Operations in Grades PK-8 *Riverboat*
- 959 Through the Lens of a 6-12 Principal: Leading the Charge on the ACT! *Schooner*
- 1340 Reading in Music: Utilizing Reading Concepts in the Elementary Music Classroom *Windjammer*

All MEGA Conference sessions will be held in the [Mobile Convention Center](#), the [Renaissance Riverview](#), the [Renaissance Battle House](#), and the [Hampton Inn](#).

WEDNESDAY JULY 10

12:45 PM - 3:30 PM

[Battle House](#)

1151 Special Education Scenarios: 2024 Version [Moonlight ABCDE](#)

[Mobile Convention Center](#)

916 Governor's Turnaround Schools - Invitation Only [Room 203A](#)

2:00 PM - 3:30 PM

[Battle House](#)

1145 6-12 Updated Math Critical Standards and New Aligned Resources: Come Check Them Out! (Repeat Session) [Crystal Ballroom](#)

1483 Bridging Reliable Relationships with Students, Parents and the Community through BARR (Repeat Session) [Leinkauf](#)

1025 I've Been Hired as a Teacher, Now What? [Treehouse](#)

[Mobile Convention Center](#)

1113 The Alabama Teacher Mentor Program (Repeat Session) [West Ballroom](#)

1123 Handwriting: Unexpected Connections (Repeat Session) [Room 105](#)

1213 ACAP Summative and the ALA: The Keys to Unlocking Proficiency and Securing Sufficiency (Repeat Session) [Room 106A](#)

1465 Educating Students with Disabilities: Frequently Asked Questions about Section 504 FAPE (Repeat Session) [Room 106B](#)

1154 Alabama's Accountability Systems: Calculations, Calculations, Calculations (Repeat Session) [Room 107A](#)

1224 Mastering the Art of Resume Writing: Unleashing ChatGPT with Alabama Career Coach [Room 107B](#)

1049 Using Ellevation to Differentiate for ELs in the GenEd Classroom [Room 201A](#)

1076 Holistically Empowering Those We Serve Through the Engagement of Community Partnerships [Room 201B](#)

779 The Data Draft...Who's on Your Team? [Room 201C](#)

1060 Instructional Innovation Showcase: Using a Problem-Solving Team Approach to Determine Cause of Student Absenteeism [Room 201D](#)

809 Mathematical Synergy: Nurturing Student Understanding Through Co-Teaching with Teachers and Tutors [Room 202B](#)

999 Say it Louder and Slower! Who Has Time for Tier 2 Anyway? [Room 203B](#)

1087 Creating Self-Growth for All Individuals on Your Campus: Authentic Dialogue is the Key to Ownership of Learning, Growth, and Success [Room 204A](#)

1171 **FEATURED SPEAKER:** Education Reality: Ensuring Our Investments Improve Student Outcomes (Repeat Session) [Room 204B](#)

1092 The Impact of Trauma on Academics and Student Outcomes: Through a Neuroscience Lens [East Ballroom](#)

925 Take Flight with Drones in Education (Elementary) [Room 202A](#)

[Riverview](#)

754 Helping Migratory Students Succeed Academically Through Supplementary Services [Bon Secour I](#)

1252 ATOT Scoring Rubric: Taking the Guesswork Out of Rating Instructional Practices [Bon Secour II](#)

830 Where Do We Start? Refining Your Practice with Cognia's Continuous Improvement Process and Accreditation Protocols [Bon Secour III](#)

1173 Recognizing Innovation in Education Through Cognia's STEM Certification Process (Repeat Session) [Clipper](#)

1301 Science of Reading: Aligning Assessment & Intervention [Grand Bay](#)

1459 A Rising Concern: Eating Disorders in Youth [Jubilee](#)

832 Trust the Process: Utilizing Math Coaches and PLCs to Grow Teacher Practice [Mobile Bay](#)

952 ACAP Alternate Item Specifications, Performance Writing Tasks, and Performance Writing Themes for 2024-2025 [Schooner](#)

1347 Developing Computational Thinking Pathways in Rural Alabama High Schools: Results and Lessons Learned [Windjammer](#)

All MEGA Conference sessions will be held in the **Mobile Convention Center**, the **Renaissance Riverview**, the **Renaissance Battle House**, and the **Hampton Inn**.

THURSDAY JULY 11

8:30 AM - 10:00 AM

Battle House

- 969 Tools to Analyze Attendance *Moonlight CDE*
- 1441 Getting Started with Gamified Learning *Treehouse*
- 998 The Multitool: Resources for the Special Educator *Moonlight A*
- 937 ACAP Alternate Teaching Strategies Toolkits *Moonlight B*

Mobile Convention Center

- 1482 **FEATURED SPEAKER:** I Need a Boost (Repeat Session) *West Ballroom*
- 759 Building A Better Sentence *Room 105*
- 1028 The Many Facets of Reading Comprehension: Where Does Strategy Instruction Fit? *Room 106A*
- 821 Certification 101 (Individuals and LEAs): An Overview of Alabama Certification Approaches for all Educators and LEA Personnel *Room 106B*
- 911 Human Trafficking 101 *Room 107A*
- 1205 Professional Development Shouldn't Be Positively Dreadful *Room 107B*
- 1148 ALSDE School Counseling and Guidance Updates (Repeat Session) *Room 201B*
- 970 Alabama State Textbook Adoption: Navigating the Maze! *Room 201C*
- 1110 ECS and DoDEA: Educating and Engaging Military-Connected Students and Their Families *Room 201D*
- 1307 Planning for Authentic Assessment in Inclusive Settings *Room 202B*
- 987 How Accurate is Your AIM? Don't Miss the Target! *Room 203A*
- 938 All Aboard for Writing for the ACT *Room 203B*
- 1384 PowerSchool Student Plans (Unified Insights) (Repeat Session) *Room 204A*
- 941 Black Belt Instructional Leadership Cohort 1- Year 2 *Room 204B*
- 1203 Alabama Power Foundation Grant Opportunities *East Ballroom*
- 1134 Classroom Management and Community Building: Secondary Edition (Repeat Session) *Room 202A*

Riverview

- 1207 Building Trauma Informed Schools *Captain*
- 1492 Best Practices for Integrating and Enhancing Creativity in the Classroom *Commander*
- 1168 Title I-A Overview (Repeat Session) *Bon Secour I*
- 1167 Homeless Education: McKinney-Vento Eligibility (Repeat Session) *Bon Secour II*
- 1162 Where do we start? Refining Your Practice with Cognia's Continuous Improvement Process and Accreditation Protocols (Repeat Session) *Bon Secour III*
- 843 The (Not So) Simple View of Writing and Instructional Implications *Clipper*
- 1016 Indicator 12: Compliance in Early Childhood Transition *Grand Bay*
- 1174 Connecting the Data: Planning for School Improvement (Repeat Session) *Jubilee*
- 1006 Empowering Young Minds with Engaging Math Discussions *Mobile Bay*
- 777 6-12 Updated Math Critical Standards and New Aligned Resources: Come Check Them Out! *Riverboat*
- 961 ACAP Summative Reports in the DRC INSIGHT Portal Interactive Reporting System *Schooner*
- 1265 Learning Links to Leverage *Windjammer*

WI-FI

Mobile Convention Center
 Network Name: Mega2024
 Password: mega2024

**Renaissance Riverview
 and Battle House**
 Network Name:
 Renaissance_Conference
 Password: mega2024

WI-FI

8:30 AM - 11:15 AM

Battle House

- 738 Gifted Updates: Essential Tools for Gifted Education *Bienville Square*

Mobile Convention Center

- 1013 Precision in Pedagogy: Yearlong and Unit Planning Using Proficiency Scales *Room 201A*

All MEGA Conference sessions will be held in the **Mobile Convention Center**, the **Renaissance Riverview**, the **Renaissance Battle House**, and the **Hampton Inn**.

THURSDAY JULY 11

10:15 AM - 11:15 AM

Battle House

- 802 America250: Strategies for Sharing Your Community's Story *Moonlight CDE*
- 715 Student-Led IEP Meetings *Treehouse*
- 1011 The Caulk and Nails: The Notice and Invitation to a Meeting/Consent for Agency Participation *Moonlight A*
- 1002 The ACAP Alternate Participation Decision-Making Tool: A Collaborative Journey Towards Effective Assessment for Alabama's Students with Significant Cognitive Disabilities *Moonlight B*

Mobile Convention Center

- 1182 Battle of the Mind: Mental Health Awareness and Self-Care for Educators and Administrators *West Ballroom*
- 862 Oh, My Word! Best Practices for Teaching High Frequency Words *Room 105*
- 1443 Closing the Digital Divides - Exploring the National Educational Technology Plan *Room 106A*
- 1377 Play It Again SAAM: A Strategic Approach to Assessment Methods (SAAM) *Room 107A*
- 1100 Teacher Expectations for Administrators to Improve Instructional Capacity *Room 107B*
- 765 Ins and Outs of the Alabama Arts Education Initiative Grant *Room 201B*
- 922 More Low-Intensity Strategies to Support Classroom Success *Room 201C*
- 927 The Twilight Zone: Learning After Dark *Room 201D*
- 828 CTE Course of Study Updates *Room 202B*
- 1036 Cohort Clarity: Getting Organized for CCR Success! *Room 203A*
- 1255 Enhancing K-5 Numeracy Skills: Five Tips for Designing Learning Experiences that Develop a Deep Understanding of Numbers *Room 203B*
- 1259 PowerSchool MTSS (Unified Insights) *Room 204A*
- 1040 Using the Alabama Teacher Observation Tool and Feedback to Improve Instructional Practice *East Ballroom*
- 1135 RoboRevolution: Unleashing the Potential of Student Engagement with Robotics (Repeat Session) *Room 202A*
- 1521 1521 The Journey to "It's a Beautiful Day" Learning Lab *Room 204B*

Riverview

- 1477 Differentiated Teacher Coaching *Admiral*
- 1490 Preparing Students with Future Skills *Commander*
- 829 Compliance Monitoring Process & Updates *Bon Secour I*
- 807 Let the Learning Community be Your PL Guide *Bon Secour III*
- 1496 Building Collective Efficacy Through Peer Coaching (Repeat Session) *Clipper*
- 1084 Indicator 13: Successful Practices in Secondary Transition *Grand Bay*
- 1175 Equitable Services for Private Schools (Repeat Session) *Jubilee*
- 899 ANA (Alabama Numeracy Act), You are ok! *Mobile Bay*
- 836 Wondering, Wiggling, and Working- Bringing Inquiry to Your Primary Classroom *Riverboat*
- 955 Using the Alabama Practice Test for the Summative Assessment to Prepare Students for the ACAP Summative *Schooner*
- 1172 Neglected, Delinquent and At-Risk Youth: A Closer Look at Title I Part D *Bon Secour II*
- 852 Elevation Platform and Instructional Strategies Overview *Windjammer*

All MEGA Conference sessions will be held in the **Mobile Convention Center**, the **Renaissance Riverview**, the **Renaissance Battle House**, and the **Hampton Inn**.

THURSDAY JULY 11

12:45 PM - 1:45 PM

Battle House

- 741 Essential Tools for Gifted Coordinators *Bienville Square*
- 951 Supporting Tier III Behaviors Using the Acting-Out Cycle *Moonlight CDE*
- 1156 Student-Led IEP Meetings (Repeat Session) *Treehouse*
- 1058 The Key Cutter: Unlocking a Continuum of Evidence-Based Positive Behavioral Interventions and Support *Moonlight A*
- 1003 Understanding the Decision-Making Process Before Considering the Alternate Assessment/Alternate Standards *Moonlight B*

Mobile Convention Center

- 1467 PEEHIP Health Insurance: Coverage for Career & Retirement (Repeat Session) *West Ballroom*
- 1243 From A.B.C. to Ph.D: Examining the Critical Ideas that Promote Achievement in 21st Century Students *Room 105*
- 799 Reading Intervention with a Certified Academic Language Therapist (CALT): K-3 and BEYOND! *Room 106A*
- 1306 Harmony in Education: Navigating Conflict, Fostering Understanding, and Reimagining Relationships within the School Environment *Room 106B*
- 1469 Play It Again SAAM: A Strategic Approach to Assessment Methods (SAAM) (Repeat Session) *Room 107A*
- 1093 Educational Neuroscience: How it Benefits Educators and Students to Learn About the Brain *Room 107B*
- 737 Federal Programs Title III and English Learners *Room 201A*
- 766 Increasing Arts Opportunities for ALL: ALSDE artlook® Alabama Dashboard *Room 201B*
- 789 Breaking Down Barriers to Prosperity *Room 201C*
- 1106 Early College Updates *Room 201D*
- 837 The ABCs of Career Tech CCRs *Room 202B*
- 1208 The Successful Re-Entry Process to Support a Smooth Transition *Room 203A*
- 1388 PowerSchool MTSS (Unified Insights) (Repeat Session) *Room 204A*
- 1383 Bite-Sized Professional Learning: Micro Certificates for Every Educator (State Approved Teams Professional Learning Hours) *Room 204B*
- 1471 Using the Alabama Teacher Observation Tool and Feedback to Improve Instructional Practice (Repeat Session) *East Ballroom*
- 891 ACCESS Virtual Learning: Allies, Alignment and ACCESS *Room 202A*
- 845 Revolutionizing Recruitment: Embracing Technology Trends *Room 203B*

Riverview

- 1079 Writing: Holding High Expectations for Secondary EL students *Admiral*
- 1020 Building Capacity for Secondary Instructional Coaches: Unlocking Hidden Potential *Bon Secour I*
- 1164 Compliance Monitoring Process & Updates (Repeat Session) *Bon Secour III*
- 1014 Indicator 11: Keys to Unlocking Evaluation Requirements and Child Find *Grand Bay*
- 775 ARP Homeless I & II: Allowable Uses of Funds and Best Practices *Jubilee*
- 988 Planning an Effective Tier 1 Math Block (K-5) *Mobile Bay*
- 1276 Keeping It Real: Using Real World Connections to Accelerate Math Growth *Riverboat*
- 980 Leveraging Lexile Measures to Enhance Literacy Instruction and Learning Outcomes *Schooner*
- 811 Utilizing Media Literacy to Build Media Savvy Students *Windjammer*
- 783 Let's Talk Title I, Part D: A Panel Discussion *Bon Secour II*

WI-FI

Mobile Convention Center
Network Name: Mega2024
Password: mega2024

Renaissance Riverview and Battle House

Network Name:
Renaissance_Conference
Password: mega2024

WI-FI

All MEGA Conference sessions will be held in the **Mobile Convention Center**, the **Renaissance Riverview**, the **Renaissance Battle House**, and the **Hampton Inn**.

THURSDAY JULY 11

2:00 PM - 3:30 PM

Battle House

- 739 Gifted Compliance Monitoring Toolkit *Bienville Square*
- 935 Best Practices for Increasing Student Attendance *Moonlight CDE*
- 1064 New Developments in Dispute Resolution: Unlocking Potential in Special Education Dispute Resolution *Treehouse*
- 1009 The Bolt: Attaching Each Component of the Measurable Annual Goal *Moonlight A*
- 1004 How do I look? Data Tells the Story! *Moonlight B*

Mobile Convention Center

- 1392 Enhancing Mathematical Instruction Using Models and Manipulatives *West Ballroom*
- 824 Powerful Paragraphs *Room 105*
- 1124 Using Sound Walls to Support and Advance Instruction (Repeat Session) *Room 106A*
- 1206 Empowering Educators: Retaining Talent, Cultivating Diversity, and Strengthening Bonds with Black Male Students *Room 106B*
- 932 Making Sense of Data to Inform Instruction: A "Using Data Process" to Improve Student Learning Outcomes *Room 107B*
- 767 On the Move with Student and Family Engagement! F.E.E.T. Family Engagement Educator Team *Room 201A*
- 1468 Teacher's Retirement System & RSA-1: Setting the Financial Foundation for Retirement (Repeat Session) *Room 201B*
- 1128 Building a Foundation for Pawsitive Behavior: A Roadmap Through Multi-Tiered System of Positive Behavior Supports *Room 201C*
- 1147 ALSDE Curriculum and Instruction Updates (Repeat Session) *Room 201D*
- 1495 Planning for Authentic Assessment in Inclusive Settings (Repeat Session) *Room 202B*
- 1466 Unveiling the Future: Harnessing STEM Excellence Through Robotics Education (Alabama South BEST Robotics) (Repeat Session) *Room 203A*
- 1055 Two Languages, One Math: Let's Figure It Out *Room 203B*
- 1386 PowerSchool Unified Insights (Student Analytics) (Repeat Session) *Room 204A*
- 1470 Alabama Teacher Growth Program (ATGP) and Alabama Teacher Observation Tool (ATOT) – A Refresher Session (Repeat Session) *Room 204B*
- 1472 Alabama Power Foundation Grant Opportunities (Repeat Session) *East Ballroom*
- 1041 ACCESS Virtual Learning: Instructional Programming and Accommodations *Room 202A*
- 1432 Master the Classroom Management Game - 4 Easy Steps to Reclaim Your Space *Room 107A*

Riverview

- 1234 Empowering Teachers: Unlocking Potential with Keys to Success and Gratitude *Bon Secour I*
- 1170 Extend Learning Through the Alabama 21st Century Community Learning Centers Grant (Repeat Session) *Bon Secour II*
- 1163 Let the Learning Community be Your PL Guide (Repeat Session) *Bon Secour III*
- 907 TAPE 101: The What, Why, When and How of CTE Program Reviews *Clipper*
- 1180 Understanding IDEA's Equity Requirements: Comparing Significant Discrepancy, Disproportionate Representation & Significant Disproportionality *Grand Bay*
- 1177 ARP Homeless I & II: Allowable Uses of Funds and Best Practices (Repeat Session) *Jubilee*
- 776 K-5 Updated Math Critical Standards and New Aligned Resources: Come Check Them Out! *Mobile Bay*
- 985 Leveraging Quantile Measures to Enhance Mathematics Instruction and Learning Outcomes *Schooner*
- 1273 Small Steps to Lead with Phenomena *Windjammer*
- 1183 Human Trafficking 101 (Repeat Session) *Riverboat*

All MEGA Conference sessions will be held in the [Mobile Convention Center](#), the [Renaissance Riverview](#), the [Renaissance Battle House](#), and the [Hampton Inn](#).

FRIDAY JULY 12

8:30 AM - 10:00 AM

Battle House

- 846 Gifted Students, Creativity, and Affective Needs...What Do We Do? *Bienville Square*
- 747 Tailoring Approaches for Rural Teacher Recruitment and Retention *Crystal Ballroom*
- 924 It's About Me, We, and Us - A Guide to a Better Well-Being *Moonlight CDE*
- 1439 The Three C's of Classroom Management *Moonlight A*
- 861 Grow Your Own Leaders *Moonlight B*

Mobile Convention Center

- 1281 Trauma Informed Leadership *West Ballroom*
- 1237 Enhancing Student Performance and Classroom Instruction by Using Online Audiobooks *Room 107A*
- 1195 Inside the Lines: How to Navigate Student Relationships *Room 107B*
- 1188 Résumé 2.0: How Students Make a Great PRE-Impression Through Their Social Media Personal Brand *Room 201A*
- 1137 Project Success *Room 201C*
- 1021 Engaged by the Bell *Room 201D*
- 1349 Unlocking Success: Navigating CTE Grant Opportunities *Room 202B*
- 931 Why Teachers BITE (Behave with Instinct, Trauma, and Emotions) *Room 203A*
- 912 Labor Trafficking: A Reality We Must Address *Room 203B*
- 1395 The Model Impact *Room 204A*
- 1295 Fueling Career Readiness with the Alabama Career Planning System *Room 202A*

Riverview

- 1189 Seal of Biliteracy for Supporting College, Career, and Workforce Readiness: Voices from the Field *Bon Secour I*
- 1385 PowerSchool Student Plans (Unified Insights) (Repeat Session) *Bon Secour II*
- 1165 Compliance Monitoring Process & Updates (Repeat Session) *Bon Secour III*
- 1361 Data Inquiry: Begin with a Question to Enhance Mathematics Instruction *Clipper*
- 1358 Developing and Using Scientific Models in the STEM Classroom *Grand Bay*
- 1169 Helping Migratory Students Succeed Academically Through Supplementary Services (Repeat Session) *Jubilee*
- 996 Add Art to Math to Multiply Understanding for Grades 3-5 *Mobile Bay*
- 764 Analyzing and Interpreting ACAP Science Data *Riverboat*
- 1027 The Number One (1) is Small, but it Can Be a Game Changer! *Schooner*

All MEGA Conference sessions will be held in the **Mobile Convention Center**, the **Renaissance Riverview**, the **Renaissance Battle House**, and the **Hampton Inn**.

FRIDAY JULY 12

10:15 AM - 11:15 AM

Battle House

- 740 Gifted Office Hours Q & A *Bienville Square*
- 1112 Revolutionizing Recruitment: Embracing Technology Trends (Repeat Session) *Crystal Ballroom*
- 1331 Post Secondary Education Options for Youth with Intellectual Disabilities *Treehouse*
- 869 Fostering Student Learning Autonomy (Student Ownership) *Moonlight B*

Mobile Convention Center

- 1191 Understanding ALACRAO: What We Can Do for You *West Ballroom*
- 1126 Oh, My Word! Best Practices for Teaching High Frequency Words (Repeat Session) *Room 105*
- 1127 Reading Intervention with a Certified Academic Language Therapist (CALT): K-3 and BEYOND (Repeat Session) *Room 106A*
- 1318 Team Student *Room 107A*
- 1057 Safety Nets for Alabama's Children *Room 107B*
- 1478 Résumé 2.0: How Students Make a Great PRE-Impression Through Their Social Media Personal Brand (Repeat Session) *Room 201A*
- 786 Opening the Door to Higher Education by Completing the FAFSA *Room 201B*
- 790 The Accountability Project: Teaching Students to be Accountable for Their Grades and Attendance *Room 201C*
- 1019 Elevating Excellence: Unlocking the Power of National Board Certification in Education *Room 201D*
- 851 World Languages Best Practices *Room 202B*
- 1348 Manipulatives: The Missing Link in Secondary Mathematics *Room 203A*
- 1473 Labor Trafficking: A Reality We Must Address (Repeat Session) *Room 203B*
- 1136 It's Time for an E-Day! Utilizing APT, PBS and Technology Tools for Planning and Student Engagement. *Room 204A*
- 1382 Growth Grading - Cultivating Learners *Room 204B*
- 1210 Listen Up! Students are Talking. Are You Listening? *Room 202A*

Riverview

- 1139 Not an Afterthought: Intentional Planning for EL Success *Bon Secour I*
- 1387 PowerSchool Unified Insights (Student Analytics) (Repeat Session) *Bon Secour II*
- 1277 Phenomenal Phenomena *Clipper*
- 1380 Rigorous Thinking Discussions with Claim-Evidence-Reasoning *Grand Bay*
- 1409 Game-Based Learning for the Science Classroom *Jubilee*
- 1322 Empowering Students by Developing a Sustainable Social-Emotional Learning (SEL) Program, which promotes Optimal Academic and Life Success for Secondary Students *Riverboat*
- 989 Authentic Integration of Computer Science and K-5 Mathematics *Schooner*
- 1256 Self-Advocacy to Student-Led IEPs: How to Get There from a Practitioner's Perspective *Windjammer*

WI-FI

Mobile Convention Center
Network Name: Mega2024
Password: mega2024

Renaissance Riverview and Battle House

Network Name:
Renaissance_Conference
Password: mega2024

WI-FI

Jacqueline Abdullah	Brittany Ching	Bonnie Garrett	Molly Killingsworth	Patience Oranika	Devin Taylor
Jennifer Adams	Angela Clark	Ellen Gates	Katryna Kinn	Kathy Padgett	Derek Thomas
Kennita Allen	Kathleen Clark	Paul Gay	Anne Kirpes	Michael Papp	Ronnie Thomas
Pernell Allen	Mona Coan	Deannia George	Cindy Klages	Anne-Marie Patrick	Jonathan Thompson
Felicia Allen	Marianalyn Coleman	Betsy Glisson	Charissa Lambert	Ann Payne	Regina Thompson
Leslie Allen	Jeremy Coleman	Khristie Goodwin	Jeff Langham	Deanise Peacock	Christina Thurman
Kim Apelgren	Rebecca Collier	Nina Graham	Ma'at Latham	Patti Permenter	Noel Tillison
Christina Aquilina	Jennifer Connell	Kemeche Green	Leslie Lausten	Rhonda Perry	Shannon Tillison
Stephanie Armbrust	Meg Copeland	Elizabeth Greene	Ron Leonard	Christopher Peterson	Jennifer Towles
Susan Arnette	Stephanie Corcoran	Connie Grier	Brad Lewis	Kyle Pinckard	Irma Townsend
Connie Arnold	Brent Cosby MS	Anna Hairston	Amanda Lightsey	Rebecca Pines	Wayne Trucks
Rhonda Ayers	Mark Coty	Shannon Hampton	Padgett Linman	John Plump	Christi Trucks
Jen Bafford	Amanda Cramer	Alisia Hansell	Anthony Little	Stephanie Pope	Malti Tuttle
Torri Barber	Eric Creel-Flores	Carolyn Harvey	Christy Lockhart	Jennifer Priest	Amy Upton
Ann Marie Batista	Mikki Crenshaw	Carli Haskovec	Kelly Lomax	Christina Puckett	Lari Valtierra
Abigail Baxter	Laura Crowe	Rachael Havey	Monica Mack	Laura Leigh Rambach	Marcus Vandiver
Stephanie Bear	Tonya Cupp	Shane Haws	LaBrenda Marshall	Sandy Resa	Sarah Wagoner
Stoney Beavers	Valerie Curtis	Kathy Haynie	Jason Marshall	Stephanie Reynolds	Pansy Walker
Mandie Bechard	Christy Dark	John Heint	Tony May	Robert Richert	Kristi Ware
Clarissa Benson	Keller Monet Davis	Maggie Hicks	Robert Mayben	Michal Robinson	Kareem Weaver
Kim Benton	Dustin Day	Robert Hill	Magon McAnelly	Antone Robinson Jr	Angela White-Knox
Lisa Berry	Emily Day	Nicole Hill	Amanda McClure	Betsy Rogers	Barbara Whitfield
Lisa Besnoy	Greg DeJarnett	Regina Hill-Sankey	Jeffery McClure	LaDonna Rudolph	Meredith Wiggins
Dena Bethel	Michelle Denney	Taylor Hilyer	Brooke McFry	Amanda Rylant	Barry Wiginton
Reeda Betts	Tyrone Dennis	Evelyn A. Hodge	Jessica McKay	Regina Sankey	Courtney Wilburn
Steve Blair	Jabaria Dent	Alicia Hodge	Tammy McMinn	Annette Scogin	Kathy Wilkins
Yatisha Blyte	Layne Dillard	Jackie Hudgins	Andy Meadows	Jamie Scott	Tessie Williams
Tanisha Boyd	Cristin Dillard	Leigh Hudon	Sally Meek	David Seale	Dana Williams
Freda Braddock	Shannon Dodd	Sherri Huff	Theresa Meyer	Kristie Shankles	Angela Williams
Hannah Bradley	Cheryl Dodson	Leslie Hughes	Leroy Miles	Jimmy D. Shaw, Jr.	Bryan Williams
Amanda Bradley	Mike Donaldson	Sarah Hughes	Aida Miles	Bianca Shepherd	Becky Wilson
Monica Bramlett	Samuella Drew	Brooke Hughston	Jan Miller	Carol Sherman	Andrea Wilson
Stephanie Branum	Donovan Dreyer	Elizabeth Huntley	Manisha Mishra	Teri Shriver	Kimberly Wilson-Woodson
Tracey Braye	Robbie Durr	Melody Ilk	Kimberly Mitchell	Jessica Silas	Joy Winchester
Staci Brooks	Colleen Edwards	Stephen Ingram	LaWanda Mitchell	Amy Siracusano	Patti Wood
Kimberly Brown	Shaundalyn Elliott	Pam Ivey	Meredith Mitchell	Kacie Slaughter	Tracey Wray
Alicia Brown	Dawn Ellis	Shonta Jackson	Chenille Mitchell-Chambers	Valerie Slay	Veronique Brown
Gabrielle Brundidge	Robin Parks Ennis	Robert Jackson	Courtney Monnette	Taurus Smith	
Blake Busbin	Robin Ennis	An Genette Jackson-Jones	Allison Moore	Susan Spezzini	
Robin Bynum	Marcia Farabee	Srinivas Javangula	Tiffany Moore	Monica Stallworth	
Patrick Cain	Shirley Farrell	Rebecca Johnson	Pamela Moorer	Kelly Stanton	
Misty Calhoun	Shannon Finley	Tashunda Jones	Holly Morgan	Johannes Starks	
Tammy Calhoun	Andrea Forehand	Carolyn Jones	Dawn Morrison	Kim Stephenson	
Leslie Calloway	Andrea Forehand	William Jones	Jessica Morse	Sean Stevens	
Shellie Carden	Tara Foster	Margaret Jones	Amy Murphy	Laura Stewart	
Adrian Carpenter	Maria Franco	Kimberly Jones	Elisabeth Newell	Janice Stockman	
Tracey Carter	LaDedra Frazier	Margaret Jones	Jane Newman	Ashley Strickland	
DaLee Chambers	Shaella Freeman	Auburn Keaveney	Gary Noles	Dana Stringer	
Yasha Chapman	Kit Gallup	Anita Kelley	Phenicia Nunn	Sam Strother	
Vickie Chappelle	Jhina Garcia-Snell	Tiffany Kessler	Sue O'Connell	Ardrinnia Strum	
Robert Chatmon	Joe Garner	Mansfield Key	Obioma Okogbue	Robin Stutts	

- 95 Percent Group
AcaSTEMics
ACCESS Virtual Learning
Adams Learning Resources, Inc.
AE Touch Technologies
Alabama AGM University College of Education, Humanities, and Behavioral Sciences
Alabama Best Practices Center
Alabama Career Planning System, Powered by Kuder
Alabama Department of Archives and History
Alabama Department of Mental Health Autism Services
Alabama Education Association
ALABAMA INDUSTRIES FOR THE BLIND
Alabama Institute for Deaf and Blind
Alabama Partnership for Children
Alabama Power Foundation
Alabama Power Public Safety Awareness
Alabama Public Television
Alabama Supercomputer Authority
American Book Company
American Federation of Teachers
Amplify.
AMT MEDICAL STAFFING
ASVAB Career Exploration Program
Auburn University at Montgomery - College of Education
Auburn University-College of Education
AVID Center
BGH Photo Video
Bailey Education Group
BARR Center
BayPointe Children's Hospital
BBB Educational Enterprises, Inc.
Beacon Children's Hospital
Big Brothers Big Sisters of Alabama
BK Royston Publishing
Blue Cross and Blue Shield of Alabama
BRAINCHILD
Carolina Biological Supply Company
Children's of Alabama
Children's Rehabilitation Service
Collaborative Classroom
Collateral Educator Services
College Admissions Made Possible (CAMP)
College of Education and Professional Studies
CollegeCounts 529 & Alabama ABLE
Columbia Southern University
ComplianceDirector
Curriculum Associates
Data Recognition Corporation (DRC)
Developing Mathematical Thinking Institute
Drug Education Council
Edpuzzle
Ellevation Education
ExploreLearning
FOSS
Glenwood
GoRescue Brands, Inc.
Governor's Office of Volunteer Services
hand2mind
Happy Feet
Horace Mann Companies
Houghton Mifflin Harcourt
It's ME Handbags
Jumpstart Test Prep
Karen Maury Jewelry
Kids First Education, LLC
Laurel Oaks Behavioral Health
Learning Without Tears
Legacy Partners in Environmental Education
Lexia
Lisa Ray's Jewelry Boutique
Mary Kay
Math Nation by Accelerate Learning Inc.
McGraw Hill
McWane Science Center
Medical Supplies Depot
Montgomery Recruiting Battalion (US Army)
n2y
NAMI Alabama
National Geographic Learning/Cengage
National Inventors Hall of Fame
Newsela
Nova Reigns LLC
OnToCollege
Origami Owl
Outreach/RISE/Special Projects
Parchment
Perfection Learning
Plasma Games
Presentation Solutions, Inc.
Public Consulting Group
PunchDrunk Digital
Regional Autism Network
Renaissance and Nearpod
Savvas Learning Company
Scholastic Education
Sight Savers America
Sista tu Sista
Studies Weekly
Sundance/Newbridge
Super Star Products LLC
Teacher Direct
Teaching Strategies
Terrell Enterprises, Inc.
The Hope Institute
The University of Alabama
The University of West Alabama Online
ThriveWay
TouShay Boutique
Troy University Online
UA Early College
University of Alabama at Birmingham School of Education
University of Alabama Office of Teaching Innovation and Digital Education
University of Montevallo Graduate Studies
University of South Alabama - College of Education and Professional Studies
VariQuest
Vision Research Corporation
VitAL
Walk in Motion
Wink Mobile Boutique
Wondr Health
Wordplay Multimedia
ZOLL Medical Corporation

SILVER SPONSORS

THANK YOU

Blue Cross and Blue Shield of Alabama

Bailey Education Group

AE Touch Technologies

University of South Alabama

College of Education and Professional Studies

Ron Austin Law

Alabama Education Association

BRONZE SPONSORS

THANK YOU

95 Percent Group

Kids First Education, LLC

Perfection Learning

Wondr Health

Lexia

Plasma Games

Teaching Strategies

Vital Alabama

Auburn University at Montgomery - College of Education

Columbia Southern University

Alabama Institute for Deaf and Blind

Public Consulting Group

UWA Black Belt STEM Education Institute

SAVE THE DATES
July 14-18, 2025
MEGA 2025



ALABAMA STATE DEPARTMENT OF EDUCATION, ERIC G. MACKEY, STATE SUPERINTENDENT OF EDUCATION

The Alabama State Board of Education and the Alabama State Department of Education do not discriminate on the basis of race, color, disability, sex, religion, national origin, or age in their programs, activities, or employment and provides equal access to the Boy Scouts and other designated youth groups. The following person is responsible for handling inquiries regarding the non-discrimination policies: Title IX Coordinator, Alabama State Department of Education, P.O. Box 302101, Montgomery, AL 36130-2101, telephone (334) 694-4717.